

KM AntPro® - Sentinel Pro Baiting System®

Installation & Operation

General: (Start Here)

When dispensers filled with **KM** use approved baits are deployed they provide a safe highly effective means to destroy ants, their colonies, and cockroaches. Performing as a Trojan horse **AntPro®** recruits ant foragers to consume and transport the disguised delayed action toxicant bait in their body's interior social stomachs back to their nests to feed and kill their queens, brood and colony. After area nests are destroyed insect activated **AntPro** provides continuous 24/7 Sentinel preventive monitoring preventing potential re-infestations.

Filling Instructions:

- 1) Turn dispenser upside down, then unscrew and remove base.
- 2) Fill dispenser through bulb stem with at least **16 oz. of liquid ant bait**. (Max liquid capacity is 19 oz.)
- 3) Insert flow switch by applying even pressure until rim of switch is evenly seated flush against the bulb stem.
- 4) Re-attach base to reservoir, then close snugly, so bait doesn't leak when dispenser is turned right side up.
- 5) Insert anchor stake into square slot in underside of base. Apply firm pressure until stake crimps into receiver.



Dispenser and assembly breakdown

Ground installation Instructions:

- 1) Place dispensers as level as reasonably possible on ground positioned away from direct sunlight in shaded areas, preferably in a shrub belt etc. (Avoid using ant bait indoors.)
- 2) Use a long screwdriver to make a pilot hole for the stake to be seated into the ground. Do not force stakes into the ground.
- 3) Insert stake, with dispenser attached, into pilot hole. Apply even downward pressure to dispenser, until stake is firmly seated in ground. (When the stake is fully inserted, the dispenser's base should sit flush on the ground. If not, make the pilot hole deeper.)
- 4) For best results, place at least one dispenser on each side of structures.
- 5) See reverse side of this document for basic placement strategy information.



Fill reservoir



Insert flow switch

Activation with Flow Switch Instructions:

- 1) Activate dispenser by rotating the reservoir (between 1/4 to 1/3 turn counter clockwise) to nearest arrow. (This procedure slightly raises the weather shield from the base while activating the dispenser's interior liquid surface tension stress ducts.) Note; Unscrewing reservoir too far can result in bait leakage.
- 2) To service; simply unscrew the bulb, invert it and extract the flow switch and replenish with *Greenway Liquid Ant Bait*.
- 3) The safety lock screw can be engaged firmly against interior receiver collar wall to help prevent tampering if technician determines this precautionary step to be necessary.

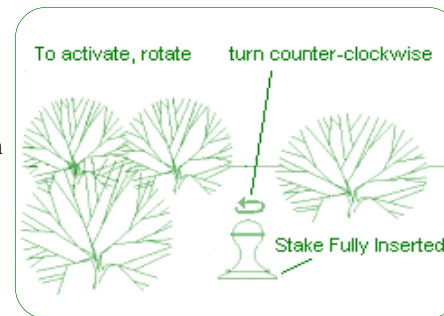

Other Instructions:

- 1) After colony elimination or control, maintain dispensers in place to prevent re-infestation. The dispensers are designed to hold and deliver bait for extended periods, but should be inspected and refilled, or replenished "topped off" with additional bait every few months as needed when adjoining and surrounding near by areas are infested with ants.
- 2) Avoid tilting or jarring dispensers once they are activated, — this disturbs the metering action and can cause bait to leak into the interior pool area unnecessarily.

Important: Do not apply additional insecticides or baits while using your **KM Sentinel Pro System®**. Although these products kill visible insects, they also serve to alert other colony members to bud their nests and reproduce more rapidly. Ant foragers are killed before they have an opportunity to return to their nests to feed their queens and colony. (For tech support contact Ken Kupfer at 941-445-4252 or Skype: kmantpro

Greenway Liquid Ant Killing Bait®

Greenway's superior performance and reliability attracting and depopulating numerous super organism tramp ant species and roach populations compels KM's complete confidence when used in conjunction with our insect activated bait delivery system.

Greenway is specially formulated to retard the development of mold and can be diluted with water or a food grade liquid in equal amounts 1 to 1 making a .5% active ingredient bait to optimize its cost and palatability to a exceptionally wide variety of ant species. ***Tramp Ants:** tend to make very large colonies and have a high demand for food sources high in carbohydrates and amino acids. This demand is met by "Mutualism" ants feeding on the sweet fecal excrement "Honeydew", of approximately 32,000 species of plant-sucking insects. In exchange ants Farm these insects providing care and protection against these insects natural predators. **Greenway Liquid Ant Killing Bait®** mimics this natural ant food successfully depopulating Argentine Ants, Little fire ants, Crazy ants, Fire ants, Pharaoh ants, White-footed ants, Big Headed ants, including thousands of other ant specie populations encountered at ecologically sensitive sites across the globe.

***Tramp ant,** is the title applied to several invasive ant species with ability to hitchhike with human travel, commerce and establish colonies in new regions around the globe.

KM AntPro® Sentinel Pro System™ - Placement Strategy

One of the first considerations when utilizing the **KM AntPro Sentinel Pro System** is where to locate the dispensers and how many are required to do the job. Whether you are eliminating ants invading or established at residential properties, office complexes, utilities, parks and ecologically sensitive conservation lands there are reliable guidelines to follow when implementing a successful depopulation, and preventive monitoring plan.

It's important to remember only a selected small percentage of ant workers from most ant colonies are delegated with foraging, raiding and farming to provide food to their nest's queens, brood and colony members. They perform their tasks by initially foraging at random utilizing their highly developed sensory smell abilities, visual cues, and memory. Only after ants have located attractive food sources do they initiate recruitment and pheromone trails, chemically marked highways to and from the food source to their nests. This means the initial randomly foraging ant scouts will locate the bait and recruit other ants to carry the perceived protein and carbohydrates food source back to feed their queens, and colonies.

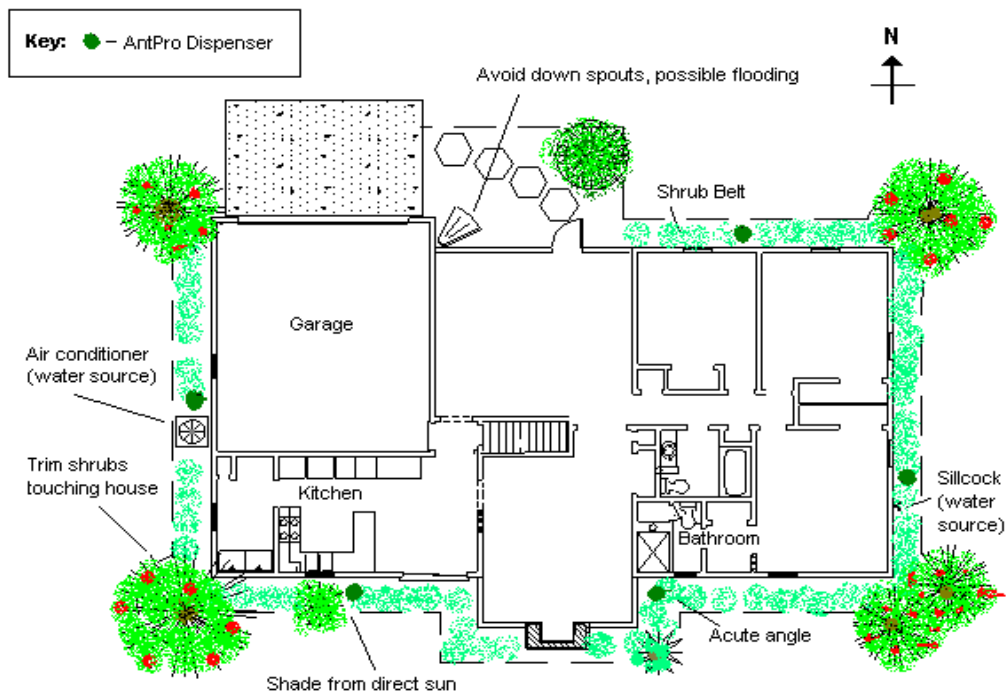

Basic deployment and monitoring around structures

1) Install at least one **AntPro®** dispenser on each side of the structure, giving consideration to its size and the number of different connecting walls. For a small house or building consisting of approximately 1500 sq. ft., place one unit at each side. The following are additional **AntPro** dispenser placement considerations:

- Key areas such as acute joining wall angles where insects converge.
- Place a unit when possible by the air conditioner condenser water overflow outlet. Water is always a primary insect attractant.

- North-side of structures with predominate shade and moisture.
- Where ants are seen trailing.
- Most important, do not put units directly over nests and ant trails; place dispensers when possible at least **5 ft. away or farther** from the nest and ant trails. **Do not disturb the ants or their nests, and especially, do not treat the area with insecticides including other baits.**
- Avoid locations where substantial horizontal water run-off may occur.

2) Basic guidelines for unit placement around buildings. The following averaged measurements are for potential invasion areas (ground floor, only).

- | | | | |
|----|----------------|-------------|----------------|
| a) | 0 – 1,900 | square feet | 4 units to 6* |
| b) | 1,901 – 2,999 | “ “ | 6 units to 8* |
| c) | 3,000 - 5,000+ | “ “ | 8 units to 12* |

* **“Exotic invasive ants”** including **Red & Black imported fire ants, Little fire ant, White-footed, Big-headed, Argentine ants, Tawny Crazy ants, Long legged ants / Yellow Crazy ants** - See Baiting Strategy 2) below, when in doubt mail samples and communicate with us.

Lawn, Garden and Balance of Property

1) For full property protection, place **AntPro** dispensers spaced around the perimeter of property. **It's the ants foraging range that matters**, depending on the ant species each dispenser covers an area with a minimum radius of approximately 30 feet (70 ft. spacing between units for Argentine and white-footed ants) to 75 ft. to 150 ft. of un-obstructed ground between units for Imported fire ants). Locate units where ants are most active; and preferably, in shrub or tree belts so as not to interfere with lawn maintenance. Deploy dispensers in continuous shade,. Avoid locations with **full sun exposure**, and where substantial horizontal water run-off will occur. **Note:** If a dispenser is submerged due to unusually heavy rain, allow the water to recede. It will not lose its bait content and foraging insects will reactivate it.

Baiting Strategy

1) **KM Sentinel Pro System™**, provides ants and other targeted insects with long term continuous access to perceived food. Initially, if you have a large infestation of ants they will consume the bait contents at a greater rate until their population is reduced and colony destroyed (most ant species). Keep in mind when these populations are destroyed other ants from outlying areas will eventually attempt to move into the uninhabited resources abundant area. Once the colony is eliminated keep the dispensers activated and in place functioning as **sentinels** to prevent re-infestation.

2) If you have a particularly difficult ant problem, first identify the ants and learn more about them. With most ant species you will find that simply following our basic installation, placement, and use instructions the problem will be resolved. In recent decades introduced alien invasive tramp ant species have and are creating serious environmental and economic problems here in the United States and worldwide.

The Argentine ant, red & black imported fire ant, and other “*Solenopsis*,” yellow crazy ant, big headed ants, Little fire ant, also known as Electric ant, Tawny crazy ant (also known as Caribbean or Raspberry ant) European fire ant, and White-footed ants are just a few of such ants.

We are engaged in ongoing global alien invasive species battles, participating and working in conjunction with governments, their environmental agencies, our USDAARS, universities, extensions, and “orgs.” Destroying and defending against the above mentioned and additional exotic invasive super organism uniclonal ant species over a period stemming in excess of two decades. It is part of our mission to discreetly convey our accumulated by concerted effort knowledge combined with strategic assistance upon your request.

KM AntPro LLC

Ofc: (941)445-4252

P.O. Box 967, Nokomis, FL 34275

Skype: kmantpro