

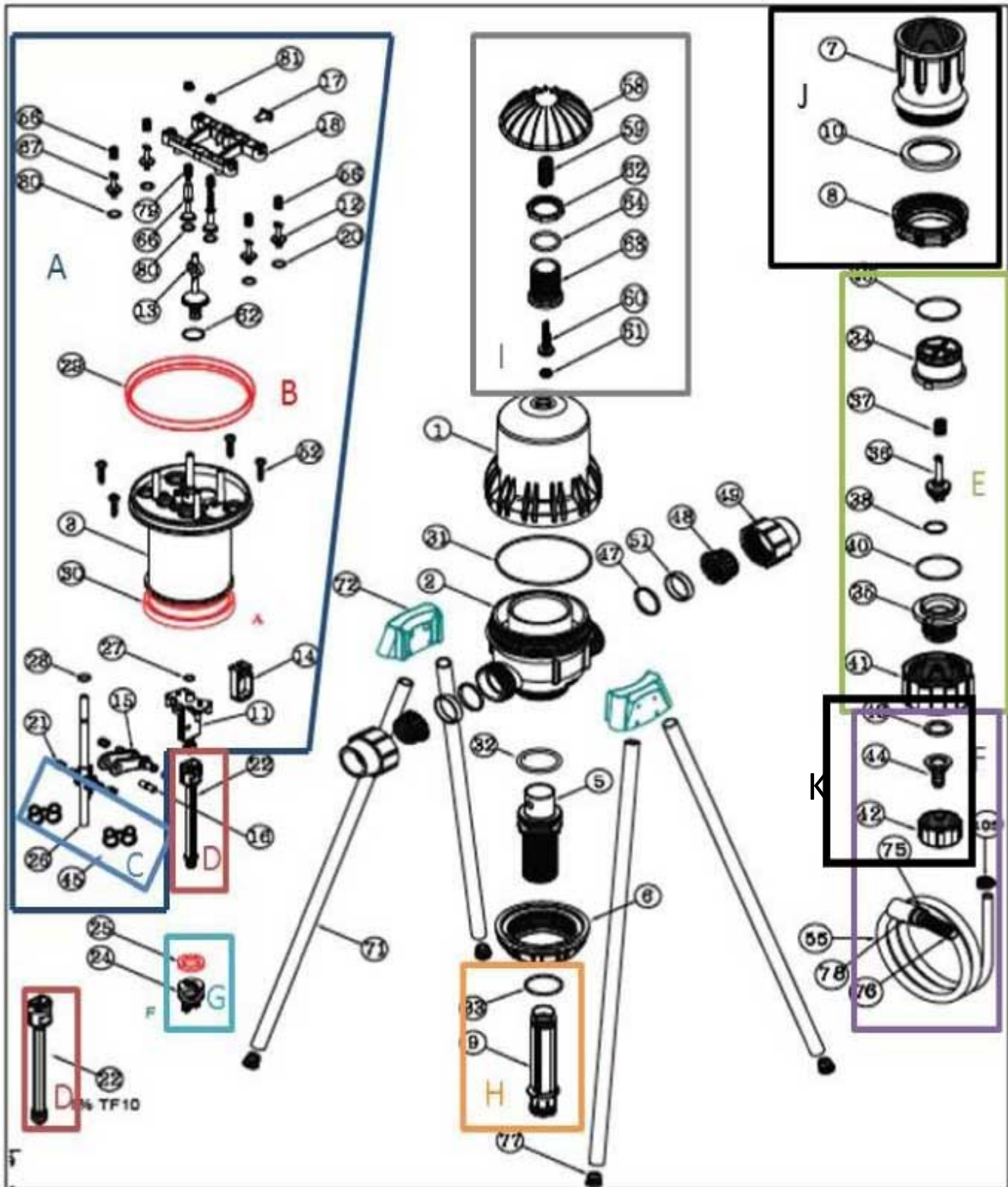

TF 10.001, F 10.002, F 10.005  
AIR RELEASE



<b>NO.</b>	<b>DESCRIPTION</b>	<b>PART #</b>
A	TF10 Engine Assembly Kit	35100000053
B	TF10 - 1% Seal Kit	35100000001
	TF10 - 2% Seal Kit	35100000002
	TF10 - 5% Seal Kit	35100000005
C	MixRite Plastic Engine Spring Kit (2 per kit)	35110000045
D	TF10 Piston Bar	35122013122
E	TF10 Chemical Check Valve Kit	35200000059
F	TF10 Suction Tube Kit	36000000028
G	TF10 - 1% Suction Piston Kit, w/ Oring	35100000019
	TF10 - 2% Suction Piston kit, w/ Oring	35100000020
	TF10 - 5% Suction Piston kit w/ Oring	35100000021
H	TF10 - 1% Suction Cylinder Kit, w/ Oring	35100000009
	TF10 - 2% Suction Cylinder kit w/ Oring	35100000011
	TF10 - 5% Suction Cylinder Kit w/ Oring	35100000012
I	TF5,10,25 Universal Air Release kit	35000000349
J	TF10 1% & 2% Adjustment Collar and Nut	35100000031
	TF10 5% Adjustment Collar and Nut	35100000032
K	12MM Hose Barb Kit, 1% and 2% models	22454752122
44	19MM Hose Barb Only, 5% models.	32454759122
1	TF10 Dome/Cover	35100000022
2	TF10 Body with 1.5" NPT Threads	35102081302
5	TF10 - 1% Cylinder Support, without O-ring	35104012304
	TF10 - 2% Cylinder Support, without O-ring	35104022304
	TF10 - 5% Cylinder Support, without O-ring	35104052304
6	TF10 Cylinder Support Nut	35105011806
31	TF10 Dome O-ring #31	38023622231
32	TF10 Cylinder Support Oring #32, EPDM	38023342332
33	TF10 Chemical Cylinder O-ring, EPDM	36023243233
41	TF5, TF10 Black Check Valve Nut	36030622100
71	Stand Legs - send 4 per unit	38000004171
72	Blue Bracket for Legs	35125011872
Not Shown	Foot valve for viscous Products 1/2", 3/4" barb (1% and 2% models)	57.12FTV
	Foot valve for viscous Products 1" barb (5% models)	57.34FTV